

WELCOME to

Chilton Academy  
Snowdonia



It is nearly September

It will soon be September and you will be coming to start your new adventure in my class. I am looking forward to seeing you back in school and helping you to learn and have lots of fun!

This booklet will help answer some of your questions about your new year at Chilton Academy!



# Meet your teacher

Hi there! I am Miss Jackson. I am new to Chilton Academy and I will be your Reception teacher in September. It is going to be a great year full of learning, new adventures and FUN! I can't wait to see what the year has in store for us!



## Fun facts about me:

Colour: **Pink**

Food: **Sunday Roast**

Book: **Room on the Broom**

Animal: **Dog**

Favourite place:  
**Edinburgh**

Enjoy: **Spending time with my family and friends and baking.**



# Your new class

## All about Snowdonia:

Snowdonia is the largest National Park in the North of Wales and it is made up of lots of beautiful landscapes and wildlife.

Snowdonia has 9 different mountains. The highest mountain is called Mount Snowdon which is very popular for walking up. As well as walking, there is a train which takes you to the top of Snowdon.



## Facts:

- Snowdonia became a National Park in 1951.
- It has 3 protected areas which contains wildlife which are at risk from extinction.
- The Welsh name for Snowdonia is Eryri.



# Early Years Curriculum

There are 7 Areas of Learning in the Early Years Foundation Stage (EYFS), which activities are planned around:

Personal,  
Social and  
Emotional  
Development

Physical  
Development

Communication  
and Language

Expressive  
Arts and  
Design

Literacy -  
Reading and  
Writing

Maths

Understanding  
the World

# Early Years Curriculum

In PSED we will learn that people have some things in common - but also the differences which make us special and unique. It also includes our relationships with others, knowing the importance of kindness and respect.

PD is learning to use our bodies and the space around us safely and imaginatively, including big movements like jumping and climbing and small movements like threading and holding a pencil.

CL is using language to understand what we hear and to express ourselves and share information - talk, listen, ask questions, explain, tell stories etc.

In Maths we learn about using numbers in lots of different ways to count, measure and solve problems. We will learn about shapes and positions of objects or patterns in the environment.

In EAD you will learn to express your ideas and feelings in lots of different ways - Art, Dance and Music.

Literacy builds on the skills learnt in CL. It also includes the development of phonic skills.

In UTW we learn about nature, places, people and important events as well as ICT.

## Reception Times

- KS1 gates open at 8:35am
- The school day finishes at 3:05pm
- Lunchtime is 11:40-12:25
- Pick up from the KS1 gate



## Your Day

- All of your learning in English and Maths will happen in the morning.
- On an afternoon, you will have PE and Science as well as topic learning which includes all the other subjects.



# Your classroom

You are in Snowdonia. This is where your classroom is:

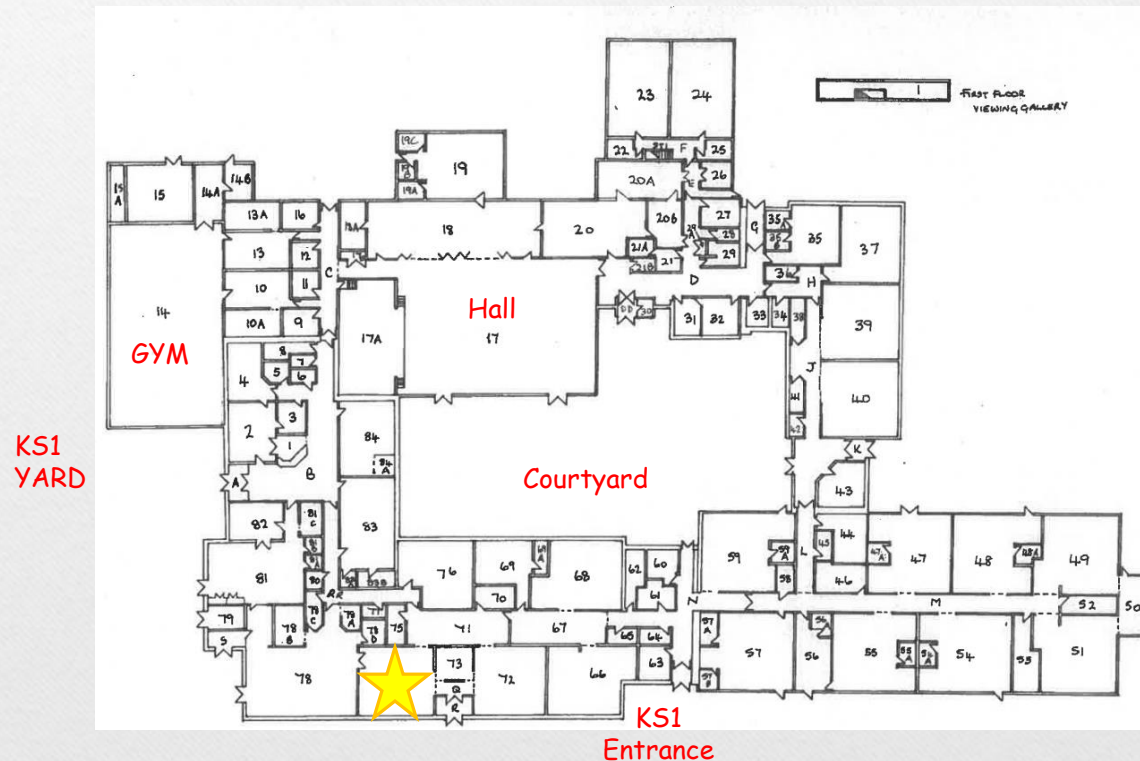

# Homework

- You will be expected to read every night at home and bring your reading book into school every day.
- You will get homework in English and Maths too - it is important to do your homework as it helps you in school.



# School Uniform

All children wear a uniform

- Navy skirt/trousers
- White shirt
- Navy sweater/cardigan
- Black solid shoes (no logos)



# PE

Your PE days are every Tuesday and Thursday.

Please come into school on these days dressed in your PE kit.

- Navy shorts
- Navy blue or white t-shirt
- Navy blue or black jogging bottoms with navy hoody/zipped up sweatshirt
- No leggings

Please bring a pair of plimsolls or trainers in a named bag to leave in school for PE days.





# Outdoors



We will be going outside for playtime and PE every day - come rain or shine.

It is much better for us if we get fresh air!

You **MUST** have a change of clothes (including socks) and a warm coat.

# Drinking...

Please remember to bring a fresh bottle of water into school every morning!



*Any bottle will do!*





## Keep in touch

- You can share things you are doing at home on your DoJo page (your parents can contact your teacher this way too if you have a problem).
- Don't forget our website  
[www.chilton.dur.sch.uk](http://www.chilton.dur.sch.uk)
- Your parents can E-mail the school on  
[chilton@durhamlearning.net](mailto:chilton@durhamlearning.net) or contact me on  
[r.jackson@chilton.durham.sch.uk](mailto:r.jackson@chilton.durham.sch.uk)  
Telephone us on: 01388 720255/721619

Have a Lovely  
Summer!

---

We can't wait to see you in September! Have a lovely summer and don't forget to stay safe!